



## TANDEM MOBI SYSTEM

# Load a Cartridge



This guide explains how to load a Tandem Mobi cartridge, which holds up to 200 units of insulin, into the Tandem Mobi insulin pump.

Before you begin, make sure to fill a new cartridge with insulin. **Flip to back side** for detailed instructions.



**Note:** These instructions are provided as a reference tool for pump users and caregivers who are already familiar with the use of an insulin pump and with insulin therapy in general. Not all screens are shown. For more detailed information on the operation of the Tandem Mobi system, please refer to its user guide.

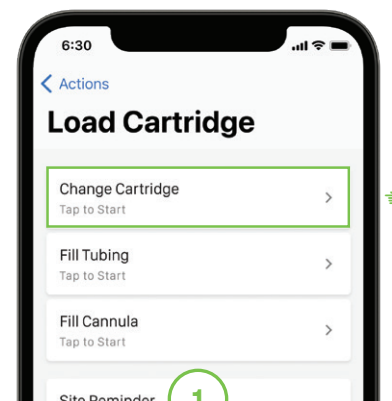

Tap **Change Cartridge**. Tap **Yes** to confirm that insulin deliveries will be stopped.



Disconnect the infusion set from the insertion site on the user's body and tap **Continue**.

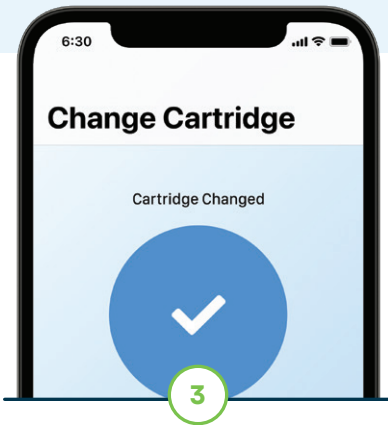

Remove the empty cartridge and place the filled cartridge on the pump. Tap **Continue**.

The Cartridge Changed screen will display. Tap **Continue**.

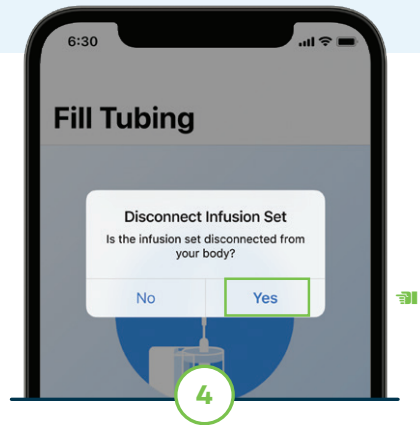

Connect the infusion set tubing to the tubing connector on the cartridge. Tap **Continue** and then **Yes** to confirm that the infusion set is still disconnected.



Hold the pump and tubing vertically to ensure any air in the cartridge will be pushed out first. Press and hold the **Pump** button to fill tubing.

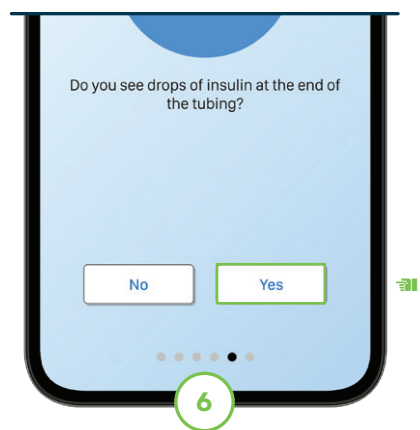

Release the Pump button after three drops of insulin are seen at the end of the infusion set tubing. Tap **Yes** to continue.

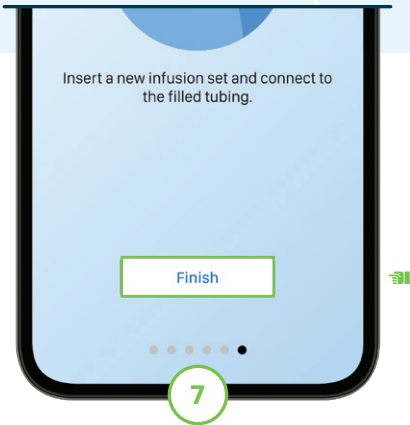

Insert the new infusion set or reconnect the filled tubing to the site, then tap **Finish**.

**Note:** Skip to step 10 if you did not insert a new infusion set or are using a TruSteel infusion set.



Tap **Fill Cannula**. Enter the amount needed and tap **Done**. Tap **Start** to continue.

**Note:** See the infusion set instructions for proper cannula fill amount.



The Cannula Filled screen will display. Tap **Finish**.

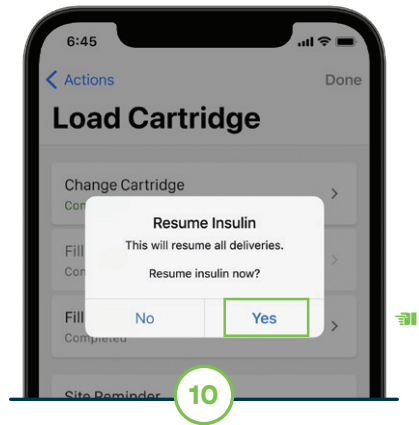

Tap **Done** and then **Yes** to confirm that all insulin deliveries should resume. A reminder to check blood glucose (BG) in 1-2 hours will display.

## Filling a Tandem Mobi Cartridge



**▲ Warning:** Some skin care products such as lotions, sunscreens, and insect repellents can cause cracks in the plastic used to manufacture the pump and cartridge. DO NOT allow these products to come in contact with the pump or cartridge. ALWAYS wash your hands before handling your pump or cartridge after using such products.

- 01 Gather an insulin vial, alcohol swab, unopened cartridge set, and infusion set, then open the Tandem Mobi mobile app
- 02 Allow insulin to come to room temperature
- 03 Inspect the cartridge set and discard any damaged product
- 04 Wash your hands and then wipe the rubber septum of the insulin vial with an alcohol swab

Open to continue →

\* The Tandem Mobi insulin pump may only be paired with one Tandem Mobi mobile app at a time. Pairing the pump with a new mobile app will remove the connection to previously connected devices.

**Important Safety Information:** RX ONLY. **Indications for Use:** Tandem Mobi insulin pump with interoperable technology: The Tandem Mobi insulin pump with interoperable technology (the pump) is intended for the subcutaneous delivery of insulin, at set and variable rates, for the management of diabetes mellitus in persons requiring insulin. The pump is able to reliably and securely communicate with compatible, digitally connected devices, including automated insulin dosing software, to receive, execute, and confirm commands from these devices. The pump is intended for single patient, home use and requires a prescription. The pump is indicated for use in individuals 6 years of age and greater. Control-IQ technology: Control-IQ technology is intended for use with a compatible iCGM (sold separately) and ACE pump to automatically increase, decrease, and suspend delivery of basal insulin based on iCGM readings and predicted glucose values. It can also deliver correction boluses when the glucose value is predicted to exceed a predefined threshold. Control-IQ technology is intended for the management of Type 1 diabetes mellitus in persons 6 years of age and greater. Control-IQ technology is intended for single patient use. Control-IQ technology is indicated for use with NovoLog or Humalog U-100 insulin.

**WARNING:** Control-IQ technology should not be used by anyone under the age of 6 years old. It should also not be used in patients who require less than 10 units of insulin per day or who weigh less than 55 pounds.

Control-IQ technology is not indicated for use in pregnant women, people on dialysis, or critically ill patients. Do not use Control-IQ technology if using hydroxyurea. Users of a Tandem insulin pump and Control-IQ technology must use the insulin pump, CGM, and all other system components in accordance with their respective instructions for use; test blood glucose levels as recommended by their healthcare provider; demonstrate adequate carb-counting skills; maintain sufficient diabetes self-care skills; see healthcare provider(s) regularly; and have adequate vision and/or hearing to recognize all functions of the pump, including alerts, alarms, and reminders. The Tandem pump and the CGM transmitter (when applicable) and sensor must be removed before MRI, CT, or diathermy treatment. Visit [tandemdiabetes.com/safetyinfo](https://tandemdiabetes.com/safetyinfo) for additional important safety information.

© 2023 Tandem Diabetes Care, Inc. All rights reserved. Tandem Diabetes Care, the Tandem logo, Control-IQ, and Tandem Mobi are either registered trademarks or trademarks of Tandem Diabetes Care, Inc. in the United States and/or other countries. ML-1012731\_A





**Drawing Insulin:** When filling the cartridge, add the amount of insulin needed for delivery, plus 5-30 units depending on the tubing length being used.

- 05 Remove the cartridge set from its sterile packaging
- 06 Pull the fill rod down completely and then push it back up to force the air out of the cartridge **(see image A)**
- 07 Pull the fill rod down to the desired volume. The top ring on the plunger should align with the desired volume marker.
- 08 With the insulin vial upright and on a flat surface, push the vial adapter down and onto the vial
- 09 Push the fill rod down to force air from the cartridge into the vial and maintain pressure on the fill rod **(see image B)**
- 10 Turn the set with the vial still secured upside down, and slowly release the fill rod. Insulin may begin to flow from the vial.
- 11 Slowly pull back the fill rod to the desired volume **(see image C)**
- 12 Pull the vial out from the vial adapter **(see image D)**
- 13 Check all sides of the cartridge for air bubbles. Air in the cartridge can take up space where insulin belongs.

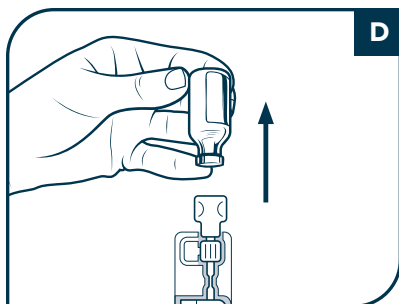
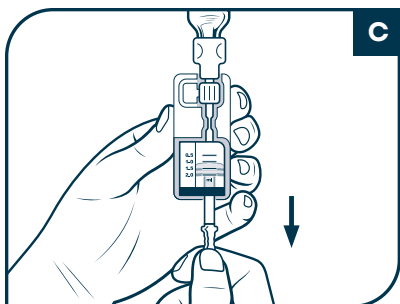
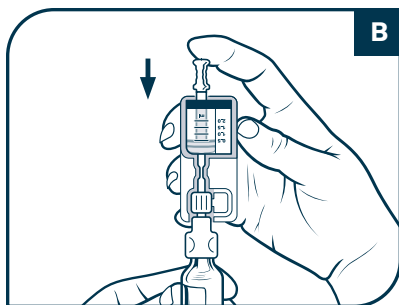
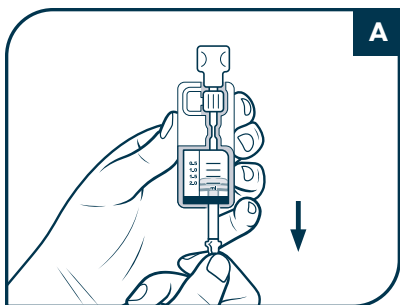

- 14 Hold the cartridge set completely upright and tap so that any air bubbles rise to the top (**see image E**)
- 15 Slowly push the fill rod upwards, forcing any air bubbles out of the cartridge
- 16 Repeat steps 13 through 15 until no air bubbles are present
- 17 Unscrew the fill rod counterclockwise to remove it (**see image F**)
- 18 Press the release tab and pull the vial adapter forward to remove the cartridge from the set (**see image G**)
- 19 Unscrew the vial adapter counterclockwise to remove it from the infusion set connector (**see image H**)
- 20 Follow instructions from local regulations to properly dispose of used needles, cartridges, set components, and infusion sets
- 21 Open the Tandem Mobi mobile app on your smartphone
- 22 From Navigation bar, tap **Actions** and then **Load Cartridge**
- 23 **Flip to the front side** and continue with instructions

